



# Glass Corner Comp Strips

Professional installation recommended

## What's included:

- 1 Vertical comp strips
- 2 Horizontal comp strips

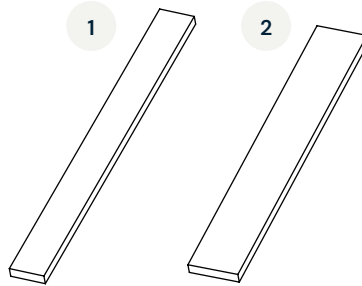

### NOTE

For use with the Pawport Glass Mount. The comp strips fill the gaps in the glass frame caused by the removal of the glass in the cutout area, providing a surface to attach the Glass Mount to. The comp strips are paintable. Do not screw into the comp strips. You may caulk or seal the edges of the strips if desired. The Glass Corner Comp Strips must be the exact thickness of your glass. Please contact Pawport Support if you did not order the correct thickness.

### IMPORTANT

Refer to the back of the page for glass cutting dimensions.

## Step 1

Slide the horizontal comp strip down until it inserts fully into the window frame and hits the bottom edge of the frame.

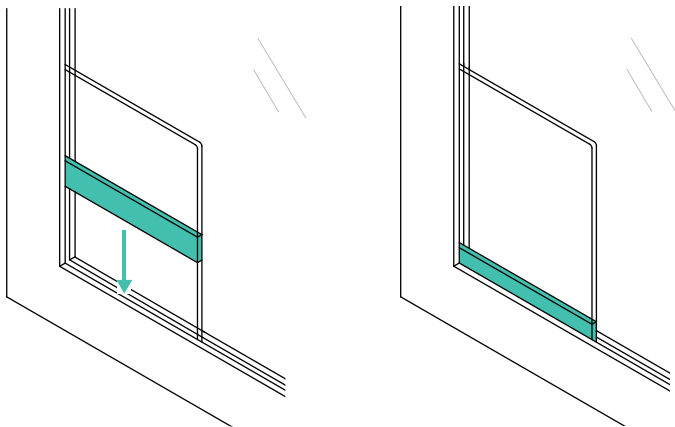

## Step 2

Insert the vertical comp strip (item 1) into the window frame opening and align so that it is parallel with the left or right (depending on installation) edge. Slide the vertical comp strip until it inserts fully into the window frame opening.

Refer to the Pawport Glass Mount Installation Manual to complete the installation.

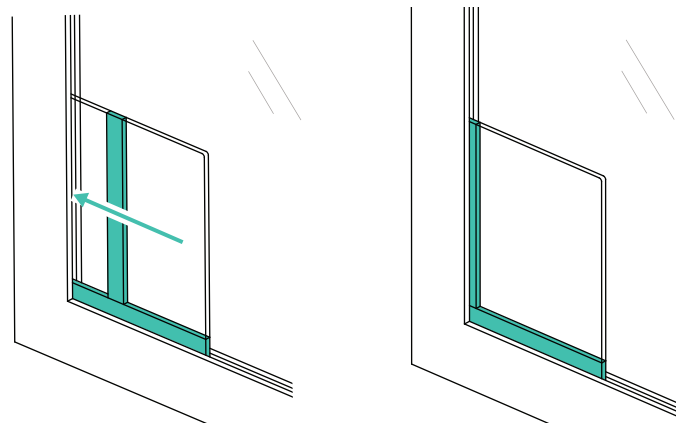

### CAUTION

This step should be performed only by a qualified glass professional. Verify all measurements and ensure the glass is fully supported to prevent cracking or breakage.

# Glass opening requirements

**IMPORTANT**

The following information is intended for professional glass cutters only. Do not attempt this if you are not a professional.

Cut the glass to the dimensions provided. The width dimensions are the same for all Smart Pet Door sizes. **Please ensure you use the appropriate height dimensions for your size Smart Pet Door.** Ensure that all cuts for the opening are level and square. Total glass pane thickness must be a minimum of .5" (13 mm) thick. The "dado" is the groove in your door or window frame that holds the edge of the glass. **In most cases, this depth is 1" (25 mm).** If your frame dado depth is not 1" please contact us. Glass must be tempered. Seal the glass panels with suitable sealant to secure all edges.

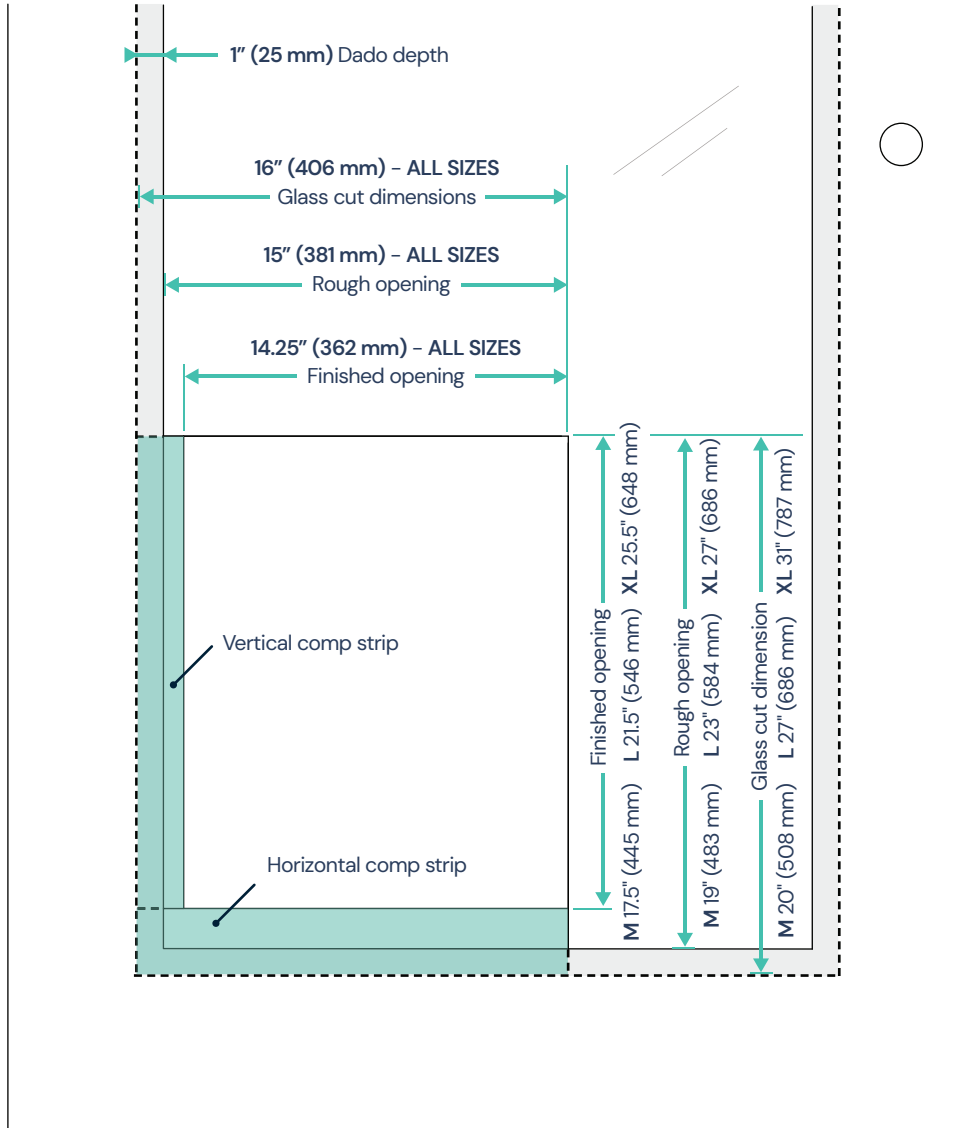

## Need help?

[www.pawport.com/support](http://www.pawport.com/support)

[support@pawport.com](mailto:support@pawport.com)

The information contained herein is protected by copyright. All rights reserved.

ID: MAN-GLACCS-2026-001

For safety information, warranty coverage, and regulatory compliance details, refer to the documentation included with the Pawport Glass Mount.